

Rinnai

FLAME FIRES



step 1 climate

Pictured on the left is a climate map of Australia that shows four winter climate zones relevant to Rinnai Heaters; Mild, Cool, Cold and Very Cold. It is important that you choose the correct zone that suits your application, as it directly relates to the performance of your heater. Detailed State maps can be found on the 'heater selector' page of our website: www.rinnai.com.au.

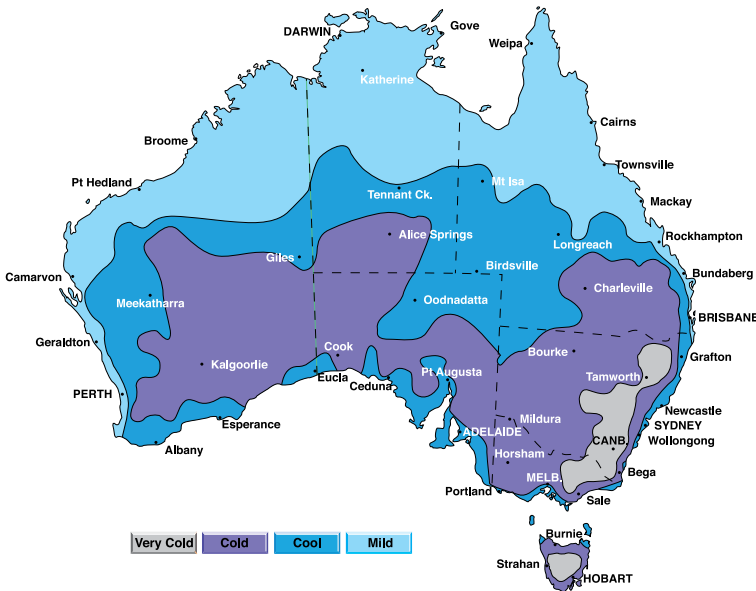

step 2 area

It is also important that you consider the total area your Rinnai heater is about to heat. This includes adjacent rooms through permanently open doorways and hallways. In this brochure, on the back page, is the approximate maximum area that the unit will heat based on the climate zones (ie Step 1). If your area is borderline based on our 'Heats up to' capacities, we recommend you select the larger model.

Calculate your selected Rinnai Heater's Capacity			
Selected Heater		'Heats up to' Capacity (see back page)	m ²
Area/Zone		Less Heat Loss 'A'	%
Total area you are going to heat (length x width)	m ²	Adjusted Capacity	m ²

↑ Your area should be less than the Adjusted Capacity ↓

✓ Heat Loss Factors		Deduct	Example
<input type="checkbox"/> No Ceiling Insulation	-15%	_____ %	
<input type="checkbox"/> No Wall Insulation	-7%	_____ %	-7%
<input type="checkbox"/> House built on stumps (not a slab)	-8%	_____ %	-8%
<input type="checkbox"/> No carpets on floors	-5%	_____ %	
<input type="checkbox"/> No drapes on windows	-10%	_____ %	
<input type="checkbox"/> Window area exceeding 15.0m ²	-15%	_____ %	
<input type="checkbox"/> Ceiling area exceeding 2.4m ²			
If Yes, height 2.5 - 2.8m	<input type="checkbox"/> -3%	_____ %	
2.8 - 3.0m	<input type="checkbox"/> -6%	_____ %	
3.0m +	<input type="checkbox"/> -9%	_____ %	
<input type="checkbox"/> Reversible Ceiling Fan (positive)	+5%	_____ %	
HEAT LOSS FACTOR	TOTAL	_____ %	A -15%

step 3 heat loss

The 'Heats up to' capacities given in this brochure are based on certain assumptions for design features of an average home. Not all homes will have all of the features listed below. Consequently, this will affect the heating capacity. Place a ✓ alongside each of the following design features only if they are relevant to your home. Everywhere there is a ✓, an adjustment to the 'Heats up to' capacity will need to be made.

Please note that this is only a guideline and individual house designs and locations may vary.

Contact the Rinnai Helpline if you require further assistance 1300 366 388.

As an example, you wish to purchase a Slimfire 25 flame fire, live in the 'Cool' zone, and have an area to heat of 65m². The recommended 'Heats up to' capacity for this model is 68m², however you also have no wall insulation and a house built on stumps. The heat loss total percentage is -15% (-7% + -8% = -15%) which is deducted from the 68m² (the capacity of your heater) as a % to reduce it to 58m². This will no longer heat your desired 65m². The next model up is the Royale Manual Inbuilt with a 'Heats up to' capacity of 93m², less the 15% heat loss = 79m², which will adequately heat the area.

FLAME FIRES

RINNAI FLAME FIRES OFFER THE LOOK AND FEEL OF TRADITIONAL HEARTH FIRES, ADDING AMBIENCE AND WARMTH TO YOUR HOME.

ASPIRATION

4 - 5

The most modern technology including full electronics, power flueing, convenient timers, temperature control and design options.

CONSTELLATION

6 - 7

Traditional design open convector flame fire providing a nostalgic look but with inbuilt modern technology.

ROYALE ETR

8 - 9

An Australian favourite, featuring both freestanding and inbuilt models with electronic timers and remote control operation.

ROYALE MANUAL

10 - 11

Simple to use push button model available in both inbuilt & freestanding configurations.

SLIMFIRE 25

12 - 13

A small compact slim line flame fire ideal for homes with smaller rooms or heating requirements.

FLUEING & ACCESSORIES

14 - 15

SPECIFICATIONS

16



ASPIRATION

WHEN ONLY THE BEST WILL DO, THE RINNAI ASPIRATION FLAME FIRE IS YOUR ONLY CHOICE. COMPRISING MANY FEATURES UNIQUE TO THE AUSTRALIAN MARKET, THE ASPIRATION EMBODIES STATE OF THE ART TECHNOLOGY WITH GREAT AESTHETICS. THESE INCLUDE FULL ELECTRONIC THERMOSTATIC OPERATION, HIGH EFFICIENCY HEATING UTILISING RINNAI'S FLEXIBLE POWER FLUEING SYSTEM AND EVEN A CHOICE OF MODERN FASCIA DESIGNS AND FINISHES.



BENEFITS.

- Power flueing allowing for a range of flueing installation options including through wall, under-floor, through ceiling, out the side whilst reducing installation costs (see page 14).
- Set'n'forget digital dual timers which allow you to program the appliance to come on & off for two set periods each day as desired - great for mornings and evenings.
- Pre-heat mode ensures the room is at your desired temperature by the time programmed into the timer. No need to program an earlier time... it's automatic!
- Temperature pre-set enables you to set your room temperature between 16°C and 26°C.
- 7 heat settings provide highly refined room thermostatic temperature control.
- Auto-Off function allows you to select whether you wish the burner to completely turn off to maintain a constant temperature, or just modulate down to the lowest flame setting.
- Flame function overrides the thermostat and maintains a constant flame picture when you just want the ambience of a fire. Select from 7 different flame patterns.
- 3 fan speed settings for added comfort and even temperature distribution.
- Inbuilt zero clearance provides heat protection to surrounding structures allowing greater flexibility and reduced installation costs, as you no longer require a masonry (non-combustible) fireplace.
- Full function remote control to allow you to enjoy the ambience of your Aspiration flame fire without leaving the comfort of your chair.

MODEL OPTIONS.

The Aspiration flame fire is available with a choice of fascias and finishes:

- Slimline Metal Fascias – Metallic Black or Stainless Steel
- Radius Full Glass Fascias – Black or Silver tint

Dress guards are also available as an accessory for added peace of mind.

Must be installed with a Rinnai flue system (see page 14).



Full Function Remote Control



Slimline Metal Fascia
- Metallic Black or Stainless Steel



Radius Full Glass Fascia
- Black or Silver

CONSTELLATION

THE NOSTALGIC IMAGE OF FIREPLACES IS BROUGHT TO LIFE WITH THE RINNAI CONSTELLATION FLAME FIRE. IN A TRIBUTE TO YESTERYEAR, RINNAI HAVE DESIGNED THIS OPEN CONVECTOR DECORATIVE FIRE WITH A CHOICE OF BURN MEDIUMS AND FASCIAS WHICH CAN BE MIXED AND MATCHED TO YOUR NEEDS. COMPLETE WITH THE LATEST ELECTRONIC TECHNOLOGY, YOU CAN ENJOY THE AMBIENCE AND ROMANCE OF AN OPEN FIRE AT THE TOUCH OF A BUTTON - THE BEST OF BOTH WORLDS!



BENEFITS.

- Ceramat[®] burner which is unique to Rinnai, assists in the creation of gentle flickering flames adding realism and ambience to the fire.
- Flame modulation allowing you to adjust the flame picture to your needs between low and high.
- Even heat distribution with a 2 speed convection fan providing added comfort.
- Electronic ignition provides simple one touch operation for ease of use.
- Inbuilt memory records your previous setting and automatically commences at that level each time until reset.
- Partial-installation option allows the flueing for the appliance to be installed during the building and framing stage. Installation of the actual fire is at completion, minimising potential mess or damage to the appliance.
- Inbuilt zero clearance provides heat protection to surrounding structures allowing greater flexibility and reduced installation costs, as you no longer require a masonry (non-combustible) fireplace.
- Off timer function allows the appliance to shut off 30 minutes after the Timer button is pushed on the remote control.
- Remote control lets you enjoy the ambience of your Constellation flame fire without leaving the comfort of your chair.

MODEL OPTIONS.

The Constellation flame fire is available in two standard configurations:

- Metallic Black with Black Coals
- Stainless Steel with River Stones

Should you ever wish to change the look of your Constellation flame fire, both the coals and river stones, as well as both fascias can be ordered separately.

Rock Panels kindly supplied by Norstone Pty Ltd.
For further information please visit www.norstone.com.au or phone 02 9944 6711.

[®]Ceramat is a registered trademark of Schott AG (Germany).
Must be installed with a Rinnai flue system (see page 14).



Remote Control



Metallic Black Fascia
with Black Coals



Stainless Steel Fascia
with River Stones

ROYALE ETR

ONE OF AUSTRALIA'S MOST POPULAR FLAME FIRES, THE ROYALE ETR BOASTS MANY FEATURES UNIQUE TO RINNAI AS WELL AS OTHER STANDARD FEATURES THAT OTHERS CHARGE FOR AS OPTIONS WHERE AVAILABLE. AVAILABLE IN BOTH FREESTANDING AND INBUILT MODELS, THE AWARD WINNING ROYALE ETR FLAME FIRE IS ONE OF THE MOST TECHNOLOGICALLY ADVANCED FLAME FIRES IN THE WORLD TODAY.



BENEFITS.

- Powerful heat output with an even spread of fan forced warm air throughout the room.
- Set'n'forget digital dual timers which allow you to program the appliance to come on or to standby for two set periods each day as desired.
- Auto-Off function allows you to select whether you wish the burner to completely turn off to maintain a constant temperature, or just modulate down to the lowest flame setting.
- Flame function overrides the thermostat and maintains a constant flame picture when you just want the ambience of a fire.
- Top mounted controls with electronic ignition allow simple one touch operation.
- Thermostatic control offers a variety of flame pictures and enhanced comfort.
- Function (child) lock when activated locks all controls providing peace of mind.
- Remote control lets you enjoy the comfort and ambience of your Royale ETR from your armchair.
- Colour options available, include Metallic Black or Titanium.

AGNEWS FIREPLACE PACKAGES.

To compliment our inbuilt fires, Rinnai have developed a range of 'Decorator Suites' manufactured by Agnews, one of Australia's leading fireplace specialists.

These suites, consisting of a range of mantles, surrounds and hearth tiles, are available through your local Rinnai stockist. Please contact them for further information and a brochure. (see page 11 for colour options).

Note: These 'Decorator Suites' are not supplied by Rinnai, your stockist must order separately from Agnews.

Clearances (Freestanding) 100mm from rear wall. 450mm from a corner. 400mm from sides and top. 1000mm directly in front.
Mandatory dress guards not shown for flame illustration purposes.
Must be installed with a Rinnai flue system (see page 15).



ETR - Electronic
with Timers and Remote



Freestanding
- Metallic Black or Titanium



Inbuilt - Metallic Black or Titanium
with Agnews Decorator Suite

ROYALE MANUAL

DESIGNED AS THE ULTIMATE IN EASY OPERATION, THE ROYALE MANUAL FLAME FIRE COMES COMPLETE WITH SIMPLE PUSH BUTTON IGNITION, 3 HEAT SETTINGS AND A POWERFUL 2 SPEED FAN FOR EVEN HEAT DISTRIBUTION AND COMFORT. RINNAI'S UNIQUE 3 BURNER SYSTEM ENSURES THE FLAME AMBIENCE IS MAINTAINED EVEN ON THE LOWEST SETTING.



BENEFITS.

- Inbuilt or freestanding configurations depending on your installation requirements.
- Powerful heat output with an even spread of fan forced warm air throughout the room.
- Electronic ignition provides simple one touch operation for ease of use.
- Radius glass fascia provides a panoramic view of the flame for added ambience.
- 2 speed forced convection fan to better meet your needs.
- 3 heat settings allow you to adjust comfort levels whilst always maintaining a flame picture.
- Finish - available in Metallic Black only.

AGNEWS FIREPLACE PACKAGES.

Decorator Suites are available for all Royale Flame Fires.

Included are a selection of mantle finishes, cast iron surrounds and hearth tile colours. A popular choice is the mantle in a raw wood condition ready for you to paint or stain to match your décor. These packages offer a cost effective way to enhance the look of your Rinnai Flame Fire.

Decorator Suite Options

Select one colour/finish from each or the following:

Mantles:	Raw, Sheraton Brown or Faded Mahogany
Cast Iron Fascia:	Classic Black, Black & Duracote™ (Polished Silver) or Full Duracote™
Hearth Tiles:	Turquoise, Burgundy, Steele Green or Cast Iron Black

Mantle Dimensions: Height 1210mm x Shelf Width 1500mm

Note: These 'Decorator Suites' are not supplied by Rinnai, your stockist must order separately from Agnews.

Clearances (Freestanding) 100mm from rear wall. 450mm from a corner. 400mm from sides and top. 1000mm directly in front. Mandatory dress guards not shown for flame illustration purposes. Must be installed with a Rinnai flue system (see page 15).



Top Mounted Controls



Freestanding
- Metallic Black Only



Inbuilt - Metallic Black Only
with Agnews Decorator Suite

SLIMFIRE 25

A TRUE SUCCESS STORY, THE RINNAI SLIMFIRE 25 WAS DESIGNED SPECIFICALLY TO MEET AUSTRALIAN CONDITIONS AND LIFESTYLES. COMPLETE WITH A SLIM-LINE FLAT GLASS FRONT AND REALISTIC FLAME AND LOG APPEARANCE, THIS CONTEMPORARY FLAME FIRE IS AN EASY WAY TO UPGRADE THE LOOK OF YOUR EXISTING LIVING AREA, OR A GREAT ADDITION TO A NEW HOME. RINNAI ALSO HAVE A RANGE OF 3 AND 4 SIDED MANTLES AND FASCIAS TO FURTHER ENHANCE YOUR DÉCOR.



BENEFITS.

- Powerful heat output ideal for small to medium sized lounge or family rooms.
- No additional flue required where installed into an existing and sound masonry fireplace saving installation costs. A complete flue kit is also available for other applications.
- Electronic ignition provides simple one touch operation for ease of use.
- Even heat distribution with a 2 speed automatic fan, gently forcing warm air throughout the room.
- 3 heat settings allow you to adjust comfort levels whilst always maintaining a flame picture.
- Colour options available, include Metallic Black or Stainless Steel

INSPIRATION MANTLE & FASCIA PACKAGES.

The new Inspiration mantles and fascias enable you to maximise the impact of your Rinnai Slimfire. Easy to install, the mantles come standard in beech or dark cherry finish. Our 3-sided fascias allow you to position the unit directly into a fireplace or on the floor, while the 4-sided fascia raises the unit from floor level. Both fascias are designed to be used with and without mantles, and are sold separately. The Inspiration packages are stocked and distributed by Rinnai.

Mantle & Fascia Options

Select one colour/finish from each or the following:

- Inspiration Mantles: Dark Cherry or Beech
- Inspiration Cast Iron Fascias: Black or Duracote™ (Polished Silver)

Mantle Dimension: Height 1150mm x Width 1360mm

Fascia Dimension: 3 & 4 sided Height 970mm x Width 970mm

Note: If not installing with a Zero Clearance box option, a separate 50mm plinth must also be ordered (see Page 15).

CONSOLE KIT.

Designed for convenience, the Slimfire Console is ideal for situations where a false fireplace is not desired or where there is no masonry fireplace, providing flexibility and reduced installation costs. Perfect as a replacement for older style gas space heaters, the Slimfire Console may be able to utilise existing in-wall flueing. The console kit is available as an optional accessory with the Slimfire 25. The flue required is a conventional 10 x 2 inch twin skin, plus a wall connection elbow and housing available from plumbing stores.

Mandatory dress guards not shown for flame illustration purposes.



Inbuilt with Inspiration Package
Fascia - Black or Duracote™
Mantle - Beech or Dark Cherry



Console Kit
- Metallic Black or Stainless Steel

FLUEING & ACCESSORIES

ASPIRATION - FLAME FIRE.

	Description	Order Code
1	Direct Flue Kit	ASPDFK
2A	Vertical 'On Wall' Kit* Co-Ax Pipe 900mm# Roof Cowl	ASPKIT03 ESPIPE900 ESROOFCOWL
2B	Vertical 'On Wall' Kit* Co-Ax Pipe 900mm# Bend (2 x 45°) Roof Cowl	ASPKIT03 ESPIPE900 ESBEND ESROOFCOWL
3A	Direct Flue Kit Co-Ax Pipe 900mm# Bend (2 x 45°) Condensate Trap Roof Cowl	ASPDFK ESPIPE900 ESBEND ESCONDK ESROOFCOWL
3B	Direct Flue Kit Co-Ax Pipe 900mm# 2 Sets of Bends (2 x 45°) Condensate Trap Wall Terminal Kit	ASPDFK ESPIPE900 ESBEND x 2 ESCONDK ESWTKIT
4	Vertical 'On Wall' Kit* Co-Ax Pipe 900mm# Wall Terminal Kit	ASPKIT03 ESPIPE900 ESWTKIT
5	Vertical 'On Wall' Kit* Co-Ax Pipe 900mm# Bend (2 x 45°) Wall Terminal Kit	ASPKIT03 ESPIPE900 ESBEND ESWTKIT

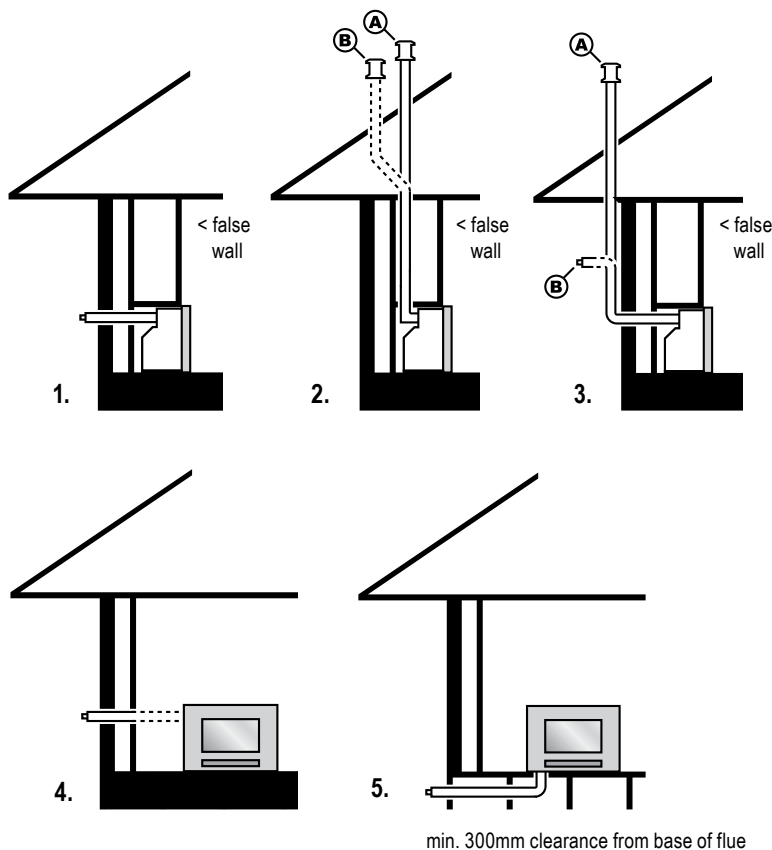

Accessories Slimline Metallic Black Fascia Slimline Stainless Steel Fascia	Order Code FLFASPPFB FLFASPPFSS	Accessories Radius Glass Black Fascia Radius Glass Silver Fascia	Order Code FLFASPPFBG FLFASPPFRSG
---	--	---	--

*includes condensate trap
#order lengths as required

CONSTELLATION - OPEN CONVECTOR.

	Description	Order Code
1	Installation Kit (3.6m) includes Adaptor, Cowl & Gal. Flue Pipe 900mm	OFKIT
2	Installation Kit (3.6m) includes Adaptor, Cowl & Gal. Flue Pipe 900mm Bend (2 x 45°)	OFKIT OFBEND
3	Installation Kit (3.6m) includes Adaptor, Cowl & Gal. Flue Pipe 900mm	OFKIT

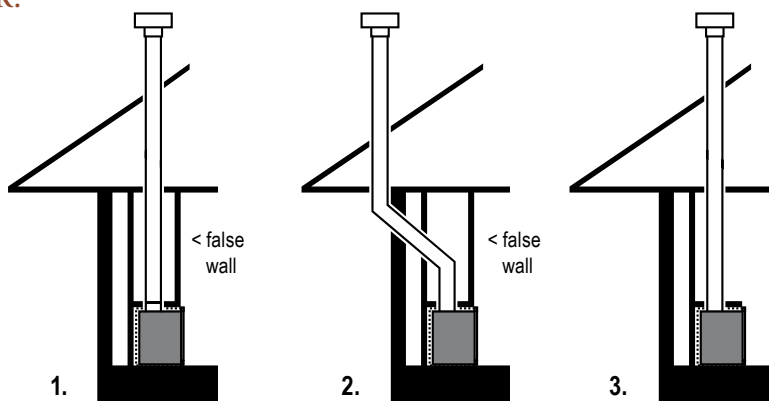

Accessories Metallic Black Fascia Stainless Steel Fascia 900mm Twin Skin Flue	Order Code FLFCONFB FLFCONFSS OFPIPE900	Accessories Black Coals River Stones	Order Code FLFCOALS FLFSTONES
---	---	---	--

Please note: Minimum flue length required is 3.6 metres

ROYALE ETR & MANUAL - FLAME FIRES.

	Description	Order Code
1A	Vertical Twin Skin Flue Kit (3.6m)	FLFKIT05*
1B	Vertical Twin Skin Flue Kit (3.6m) Twin Skin Offset	FLFKIT05* FLFBEND*
2	Thru-wall Twin Skin Flue Kit (3.6m) inc. 1x900mm Powder Coated & 3x900mm Galvanised Twin Skin Flues, Cowl & Wall Penetration Kit	FLFKIT03*
3	Flexiliner Flue Kit (5.0m)	FLEXLINER05
4A	Vertical Twin Skin Flue Kit (3.6m)	FLFKIT05B
4B	Vertical Twin Skin Flue Kit (3.6m) Twin Skin Offset	FLFKIT05B FLFBENDB

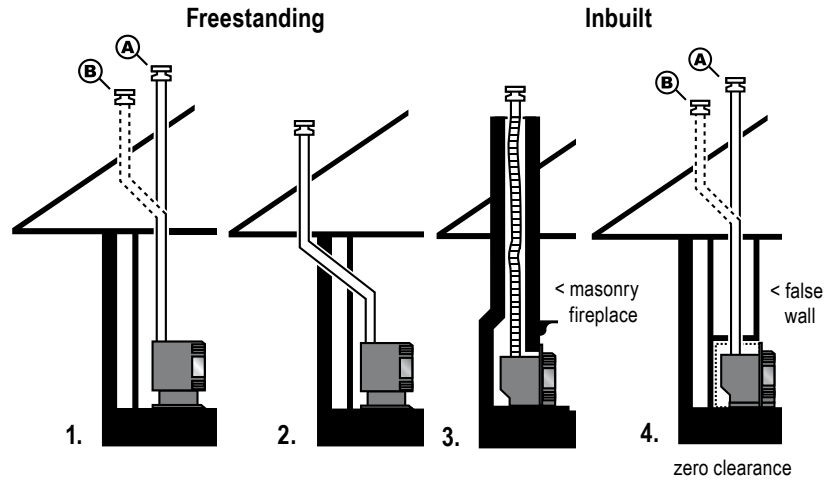

Zero Clearance Frame Dimensions (See installation instructions for full details)	745mm H x 810mm W x 440mm D (min.)	Metallic Black Zero Box	ZEROR1
		Titanium Zero Box	ZEROR2T

Freestanding Accessories	Order Code	Inbuilt Accessories	Order Code
450mm Twin Skin Flue	FLF0450M*	Flue Adaptor Plate	FLFAD
900mm Twin Skin Flue	FLF0900M*	50mm Plinth	FLFRP*
45° Twin Skin Offset	FLFBEND*	45° Twin Skin Offset	FLFBENDB
900mm Galvanised Flue Ext Twin Skin	FLFEXT03	40mm Ext Top Surround (Black Only)	FLFRSEXTB

For Thru-Wall double storey applications, please order the 3.6 metre Thru-Wall Twin Skin Kit (FLFKIT03) and additional lengths of 900mm Galvanised Flue Extensions (FLFEXT03) as required.

*Nominate Metallic Black or Titanium

SLIMFIRE 25 - FLAME FIRE.

	Description	Order Code
1	Flexiliner Flue Kit	FLEXLINER03
2A	Vertical Twin Skin Flue Kit	FLFKIT05
2B	Vertical Twin Skin Flue Kit Twin Skin Offset	FLFKIT05 FLFBEND
3	Vertical Twin Skin Flue Kit Thru-wall Twin Skin Flue Kit	FLFKIT05 FLFKIT03

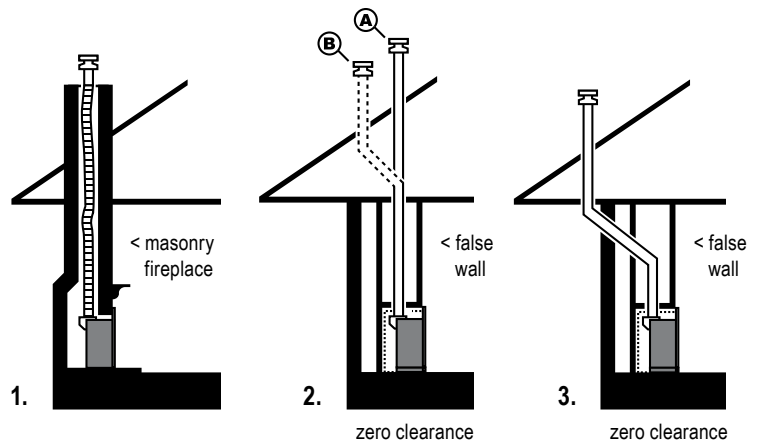

Zero Clearance Frame Dimensions (See installation instructions for full details)	675mm H x 685mm W x 370mm D (min.)	Metallic Black Zero Box	ZEROS
		Stainless Steel Zero Box	ZEROS2

Accessories	Order Code	Accessories	Order Code
Metallic Black Fascia	FLFSFB	Fluebox Adaptor	FLFAD1
Stainless Steel Fascia	FLFSFSS	50mm Plinth (Masonry Fireplaces only)	FLFSP*
Metallic Black Console Kit	FLFSCB	90mm Ext Top 3-sided Surround (Black only)	FLFSBEXT
Stainless Steel Console Kit	FLFSCSS		

#Nominate Metallic Black or Stainless Steel





RINNAI AUSTRALIA PTY. LTD.

10-11 Walker Street Braeside VIC 3195

ABN 74 005 138 769

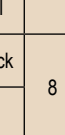
		telephone	facsimile
Technical HelpLine & Spare Parts	National (Mon-Fri 8.00am to 6.00pm EST)	1300 366 388	1300 300 141
Product Sales & Service	National	1300 555 545	1300 555 655
Brochure Request Line	National (Mon-Sun)	13 14 19	
Showrooms	Sydney (Mon-Fri)	62 Elizabeth Street Wetherill Park NSW 2164	
	Melbourne (Mon-Fri)	10 - 11 Walker Street Braeside VIC 3195	
	Adelaide (Mon-Fri)	40 - 42 Tikalara Street Regency Park SA 5010	
	Perth (Mon-Sun)	Home Base Expo 55 Salvado Road Subiaco WA 6008	

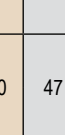
FLAME FIRE SPECIFICATIONS.

Model	Style	Dimensions (mm)			Inbuilt Fireplace Dimensions Min-Max (mm)			Star Rating AS4553/AG103: 2000	Colours	Gas Input - MJ/h		kW Output	'Heats up to' Capacity (m ²)				Order Code Nominate N or L after code for Natural Gas or LPG model.		
		H	W	D	H	W	D			Low	High		Very Cold	Cold	Cool	Mild			
Aspiration	Slimline Metal	680	900	450	660	860	450*		Met.Black	8	31.5 ¹	6.0	47	56	74	85	ASPENG (Fire) ASPFBB (Fascia) ASPENG (Fire) ASPFSS (Fascia)		
									S/Steel										
	Radius Glass	680	900	480	660	860	450*		Met.Black	8	31.5 ¹	6.0	47	56	74	85		ASPENG (Fire) ASPFBBG (Fascia) ASPENG (Fire) ASPFRRSG (Fascia)	
									Silver										
Constellation	Black Coals	680	1025	422	665	1000	450	N/A	Met.Black	24	38	N/A	N/A	N/A	N/A	N/A	CON1000B		
	River Stones	680	1025	432	665	1000	450		S/Steel	24	38	N/A	N/A	N/A	N/A	N/A	CON1000SS		
Royale ETR	F/Standing	755	650	560	N/A	N/A	N/A		Met.Black	8	35	7.4	66	79	106	122	RFSTR05		
									Titanium								RFSTRT		
	Inbuilt	695	910	565	595-675	600-800	Min. 405			Met.Black	8	33	6.6	58	69	93	109	RIBTR05	
										Titanium								RIBTRT	
Royale Manual	F/Standing	755	650	560	N/A	N/A	N/A			Met.Black	16	35	7.1	66	79	106	122	RFS05	
	Inbuilt	690	910	565	595-675	600-800	Min. 405				Met.Black	16	33	6.8	58	69	93	109	RIB05
Slimfire 25	Inbuilt	645	750	385	550-630	595-700	Min. 360				Met.Black	7.7	25	5.0	42	50	68	77	SIB
											S/Steel								SIBS

WARRANTY.

	Free Parts	Free Labour
Heat Exchanger	10 Years pro-rata [#]	1 Year
Fan	2 Years	1 Year
All Other Parts	1 Year	1 Year

Please note: 240V power is required on all models. A power cord and plug is fitted. If hardwiring is required, consult a licensed electrician.

Dimensions are subject to production tolerances and may vary slightly from those given. Rinnai Australia Pty. Ltd. reserves the right to make modifications and change specifications without notice.

[#]Heat exchanger: full replacement parts cost in the first year, reducing 10% per year thereafter.

^{*}Suitable for direct, vertical or horizontal flueing. 500mm required for down and out applications. See installation instructions for full details.

¹Installed with a direct flue with extended flueing, 24.5 MJ/h input but with a higher efficiency.

Phone 13 14 19 for a free brochure on the products listed below.

- Continuous Flow Hot Water
- Solar Hot Water
- Electric Hot Water
- Commercial Hot Water
- Portable & Space Heating
- Barbecues & Outdoor Heating

Alternatively visit our website: www.rinnai.com.au or e-mail: enquiry@rinnai.com.au